

LOT 3
299,832.4 SQ.FT.
6.88 ACRES

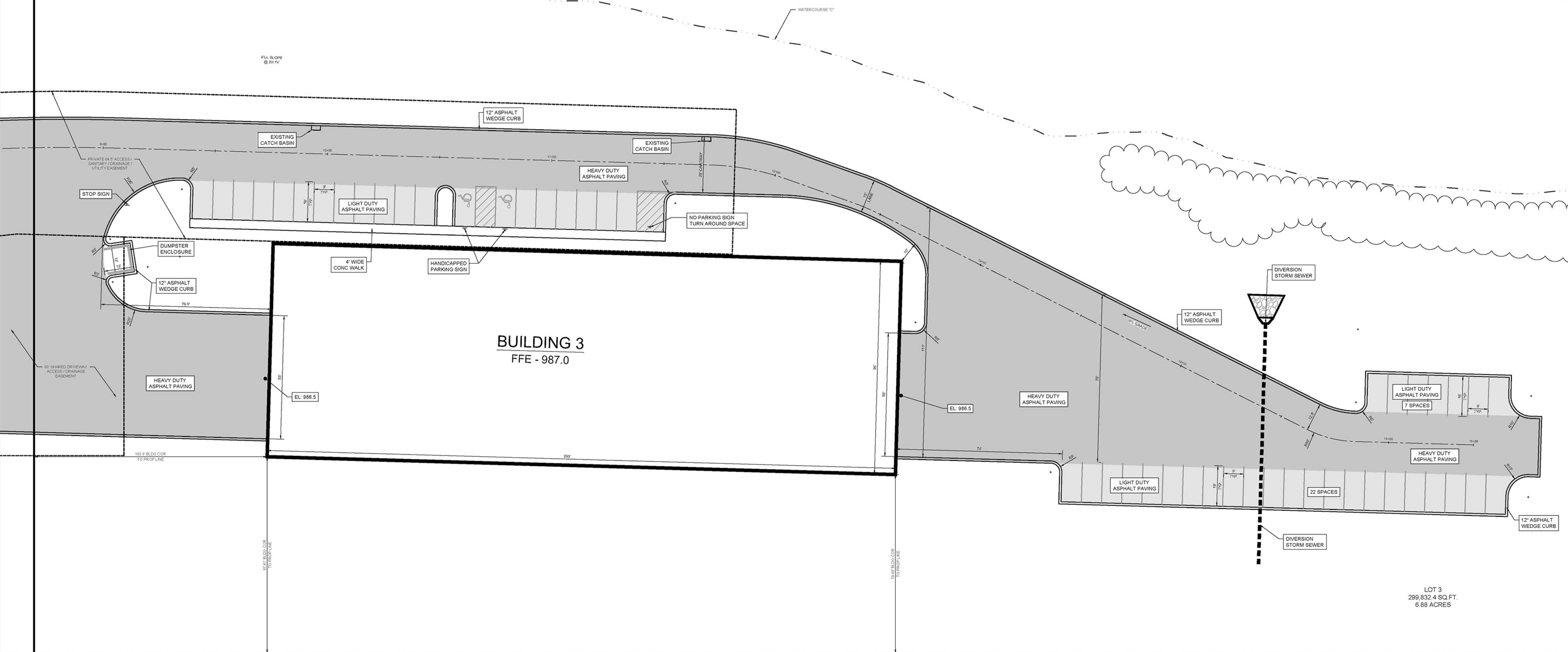

LOT 3
299,832.4 SQ.FT.
6.88 ACRES

N/E
VOSSLER, ANTONETTE L. ET AL.
TAX MAP NO. 893-M-240
DIV-PG. 8218-84
ZONED: MU

N/E
VOSSLER, ANTONETTE L. ET AL.
TAX MAP NO. 893-M-240
DIV-PG. 8218-84
ZONED: MU

811 Know what's below.
Call before you dig.

POCS SER. #: 20162141504 DIG

THE LOCATIONS OF EXISTING UNDERGROUND UTILITIES ARE SHOWN IN AN APPROXIMATE WAY ONLY AND HAVE NOT BEEN INDEPENDENTLY VERIFIED BY THE OWNER OR ITS REPRESENTATIVE. THE CONTRACTOR SHALL DETERMINE THE EXACT LOCATION OF ALL EXISTING UTILITIES BEFORE COMMENCING WORK AND AGREE TO BE FULLY RESPONSIBLE FOR ANY AND ALL DAMAGES WHICH MIGHT BE OCCASIONED BY THE CONTRACTOR'S FAILURE TO EXACTLY LOCATE AND PRESERVE ANY AND ALL UNDERGROUND UTILITIES.

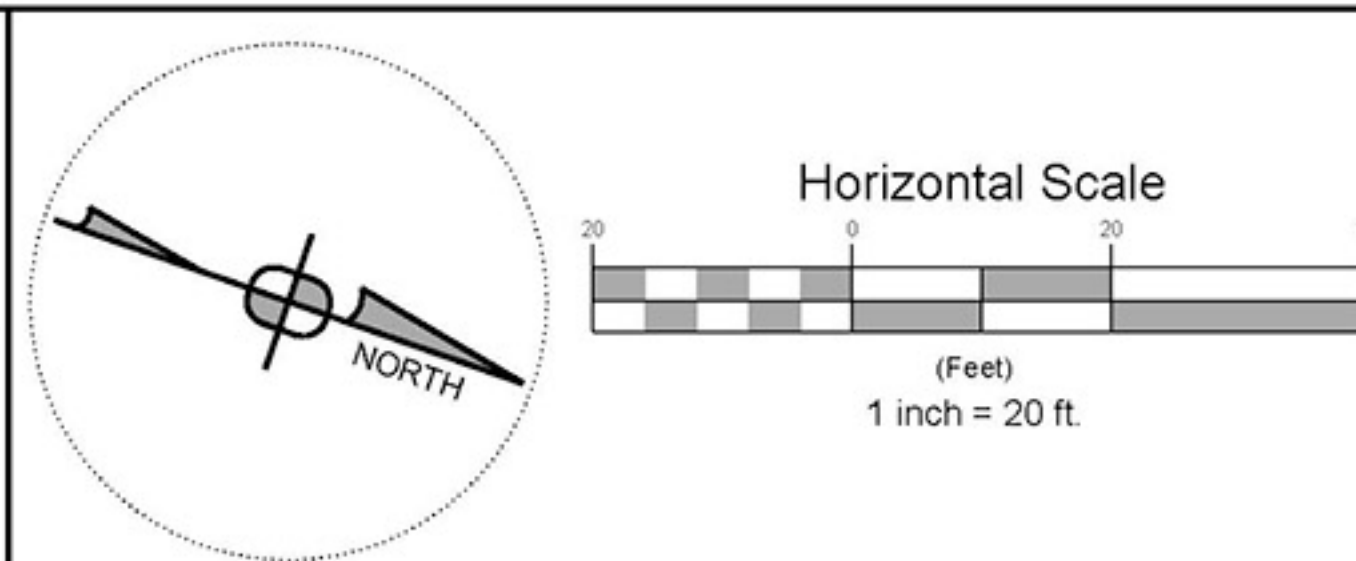

Date:	Revision Description:	By:
05/22/2020	REVISED PER TOWNSHIP COMMENTS	AGM
05/08/2020	REVISED PER TOWNSHIP COMMENTS	AGM
05/17/2020	REVISED PER TOWNSHIP COMMENTS	AGM
07/31/2020	INITIAL NPDES SUBMISSION	GLF
09/03/2020	REVISED PER MUNICIPAL AUTHORITY COMMENTS	JRG
04/17/2023	REVISED BUILDING LAYOUT LOT 3	AGM

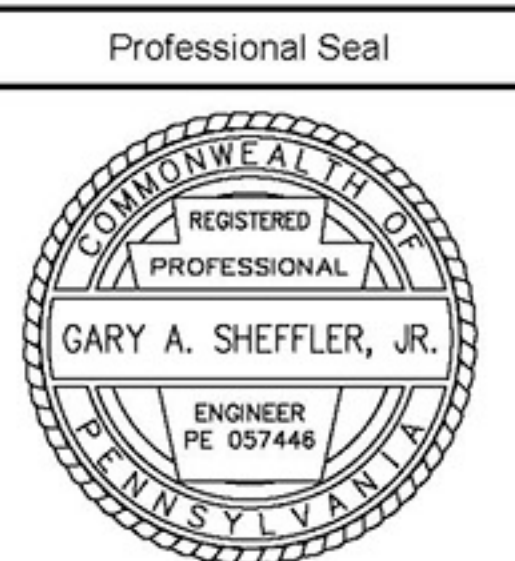

Prepared By:

Sheffler & Company, Inc.
ENGINEERING • SURVEYING

1712 Mount Nebo Road
Sewickley, PA 15143
Office Phone: 412-219-4509
Email: info@shefflerco.com

**MCCLAREN ROAD PROPERTY
PRELIMINARY / FINAL LAND DEVELOPMENT**

Prepared For:
McClaren Road Properties

Situate In:
Findlay Township, Allegheny County, PA

LOT 3 SITE PLAN	
DRAWING SCALE: 1" = 20'	DESIGNED BY: AGM/JRG
DATE ISSUED: 05/11/2020	REVIEWED BY: GAS
PROJECT JOB#: 3628	FIELD BOOK #: MCLR1
CADD#: LOT 3 R20230417-McClaren Road - C300 - Grading Plan.dwg	

MCCLAREN ROAD PROPERTIES
534 WASHINGTON AVENUE
PITTSBURGH, PA 15106
PH: 412-812-2073

Sheet No.
C200